

2000-CH EXAMINATION CHAIR

Effortless cradle tilt recline for today's modern practice

- Cradle tilt recline and perfect counterbalance
- Convenient, one-handed release and control mechanism accessible on both sides of the chair
- Kleen Tech® Lift System for responsive, smooth, and powerful hydraulic lift
- Sturdy head and neck support with single-handed control and easy headrest positioning
- Reliable non-slip lock
- Individually retractable armrests
- Upholstered for maximum comfort
- Solid construction supports ingress and egress
- Large, stable footrest delivers sturdy support and retracts conveniently when not needed



2000-CH EXAMINATION CHAIR

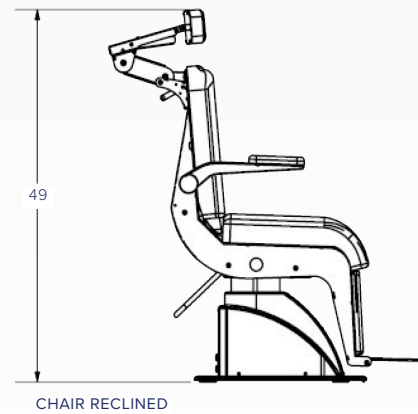
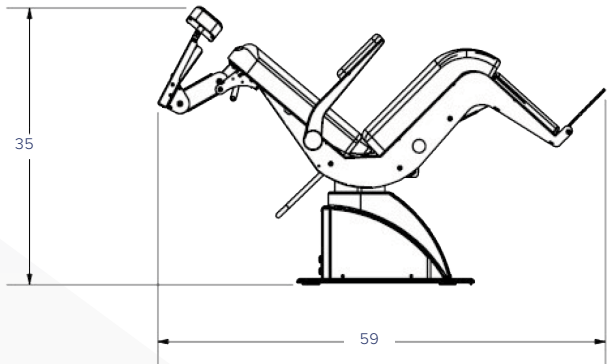
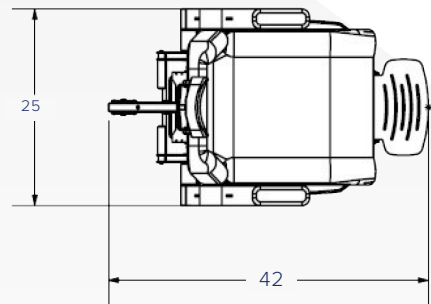

CHAIR RECLINED

IEC C14 INPUT POWER MODULE
(TAKES POWER CORD WITH IEC C13 END)

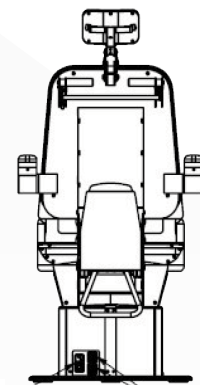

7 POSITION CPC CONNECTOR
(TAKES FOOT PEDAL CABLE)

TECHNICAL SPECIFICATIONS:

Shipping Weight: 301 lb
Gross Weight: 261 lb
Baseplate: 22"x23.25"
Lift Capacity (lb): 350 lb
Ground to Seat: 21"
Seat raises to 29.5" and lowers to 21"
Lift Column Stroke: 8.5"
Rotation: 360°
Tilt Mechanism: Cradle Tilt
Input Voltage: 100-240 VAC, 50/60Hz
Fuses: 8A Main

No special training required for the safe use of these devices. Please refer to the owner's manual for cautions, precautions, and other safe use instructions.